

# SUMMARY OF PROJECT COORDINATES

BASED ON AN ASSUMED COORDINATE SYSTEM

ROUTE	STATION	COORDINATES		BEARINGS
		NORTH	EAST	
8 15 326 1 0	38+50.00	5167.3224	4972.4938	S619°33'E
	40+95.00	4923.8141	4999.4882	S82°53'9"E
	43+50.00	4671.5676	5036.8606	

NOTE: FIVE (5) PLACE COORDINATES ARE USED FOR COMPUTATIONAL PURPOSES ONLY AND DO NOT IMPLY A PRECISION BEYOND THREE (3) PLACES.

CONSTRUCTION BENCH MARK:  
 STATION 43+28.66, 1.40' RT.  
 PK NAIL  
 ELEVATION: 101.61  
 NORTH: 5032.3491  
 EAST: 4692.4713

PROPOSED STRUCTURE DATA:  
 STA. 41+37.00 C7SUNNYSIDE ROAD  
 TYPE OF STRUCTURE: PRESTRESS CONCRETE  
 SPREAD BOX BEAM  
 SPAN ALONG C7SUNNYSIDE ROAD: 56'-0"  
 VERTICAL CLEARANCE: 17'-6" FT  
 SKEW: 79°00'00"  
 ROADWAY PAVEMENT: 24.00 FT

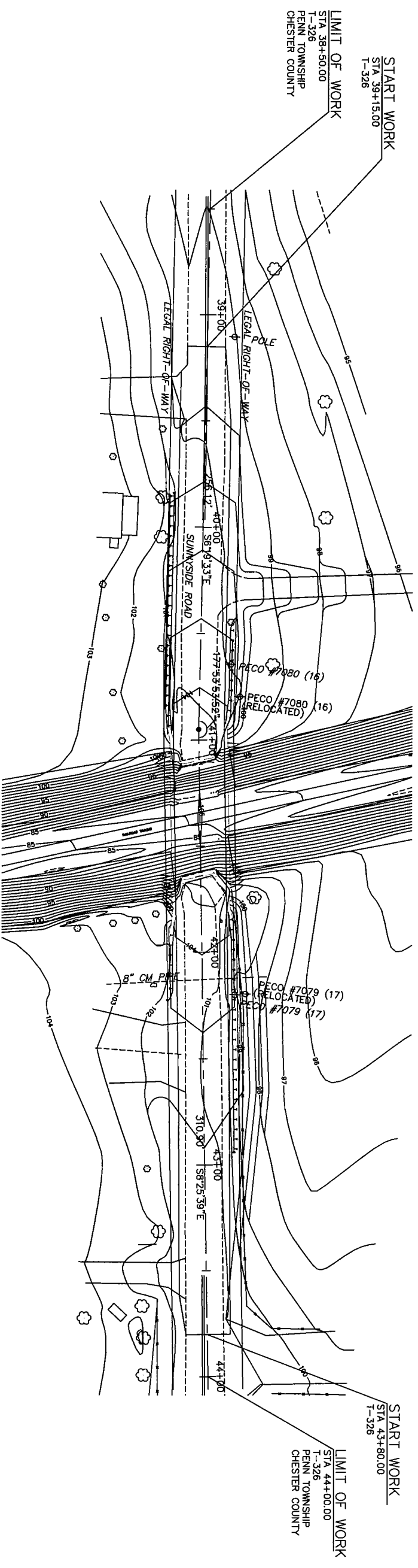

NOTE:  
 1. ROAD TO BE CLOSED DURING CONSTRUCTION

PREPARED BY:  
 MCCORMICK TAYLOR, INC.  
 CONSULTING ENGINEERS  
 GREAT VALLEY, PA.

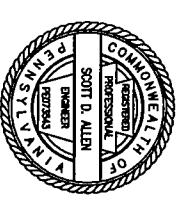

SCOTT D. ALLEN, P.E.

DATE